

ROLLING MOSQUITO SCREEN

ASSEMBLY MANUAL





IMPORTANT

It is important for the safety of persons and the integrity of the product to read these instructions carefully before installing, operating, repairing or using the screen for the first time.

This document is an integral part of the titled mosquito screen model and is intended for the installer. It contains specific information regarding its cutting and a complete guide of the sequence of operations for its assembly and installation.

It also contains information required to give presumption of conformity with the European Construction Products Directive and European Standard EN 13561:2004+A1:2008 as per the accompanying documents.

Information on general requirements for the use, handling, installation, maintenance and disposal of the mosquito net can be found in the document

"Mosquito screens: prescriptions for the user and installer" available at gimenezganga.com.

Both documents make up a complete instruction manual and an essential tool to properly operate your mosquito screen during its life cycle: installation, use, maintenance and disposal at the end of its useful life.

We recommend that you download both documents and keep them linked to the mosquito screen for future reference. The information they contain is an essential part of the product.

TABLE OF CONTENTS

01 COMPONENTS	04
02 ASSEMBLY	05
2.1 DIMENSIONS OF THE OPENING	05
2.2 PROFILE CUTTING AND ALLOWANCES	05
2.3 END CAP ASSEMBLY	06
2.4 INSTALLATION OF THE QUICK FASTENING KIT	07
03 INSTALLATION STEPS	08

01 COMPONENTS

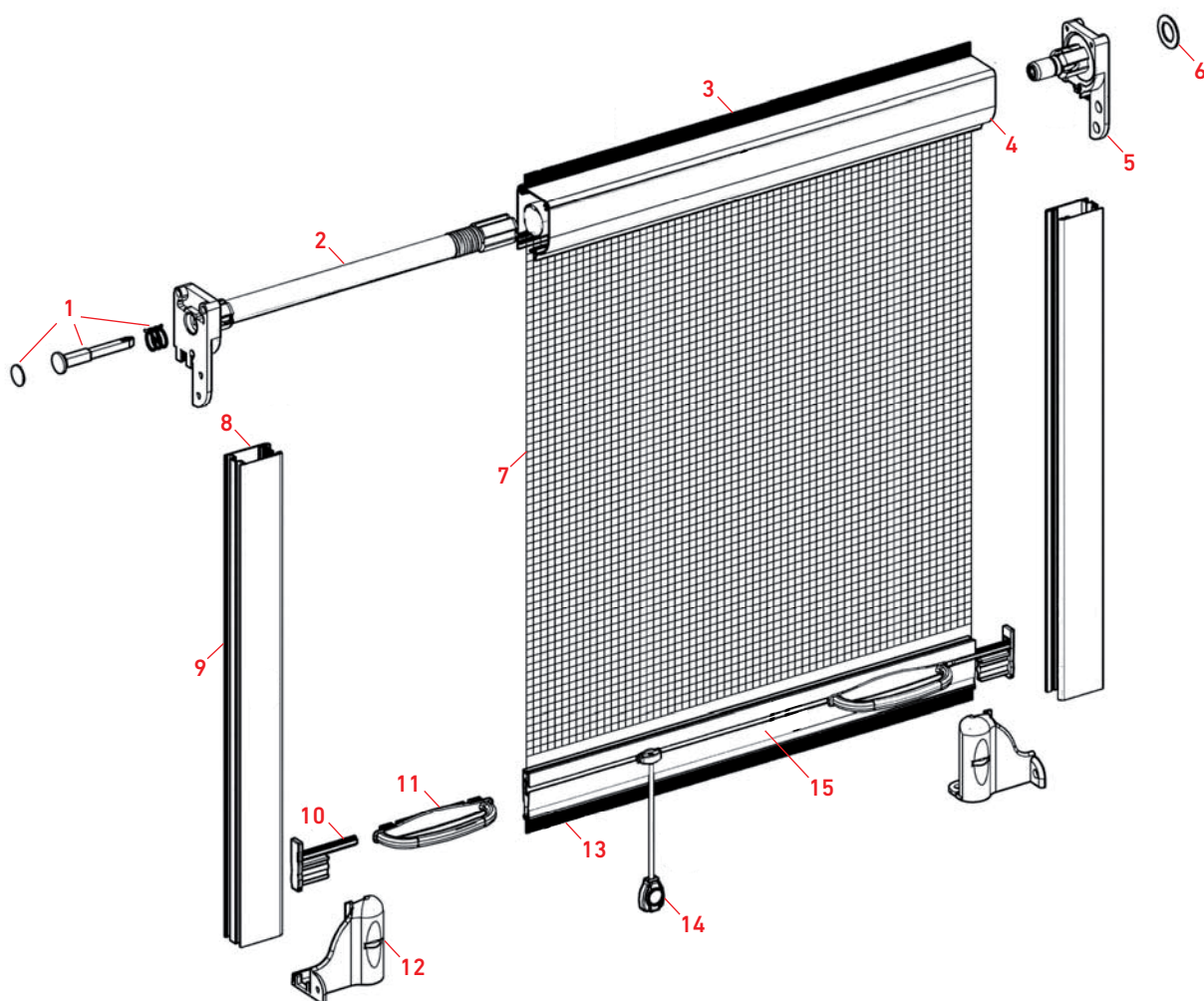

REF.	DESCRIPTION
1	- Quick assembly kit
2	008669 End cap with spring
3	- Cover brush
4	- Cover
5	- End cap without spring
6	- Anti-slip ring
7	- Axle and mosquito netting
8	- Windbreaker brush

REF.	DESCRIPTION
9	008621 Mosquito screen guide
10	008004 End cap
11	008314 Handle
12	008699 Adjustable hook
13	- End brush
14	008691 Pull cord
15	008093 Terminal

02 ASSEMBLY

2.1 DIMENSIONS OF THE OPENING

Take measurements of the dimensions of the opening where we are going to install the mosquito screen. It is advisable to take two measures of each dimension (height and width) and use the shorter of the measurements to cut the profiles.

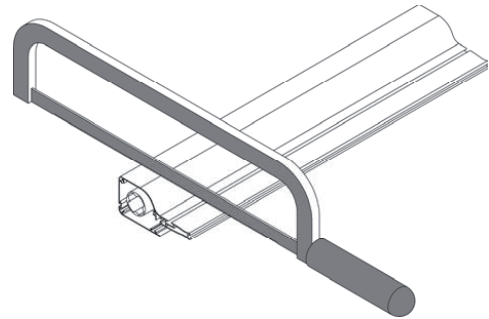
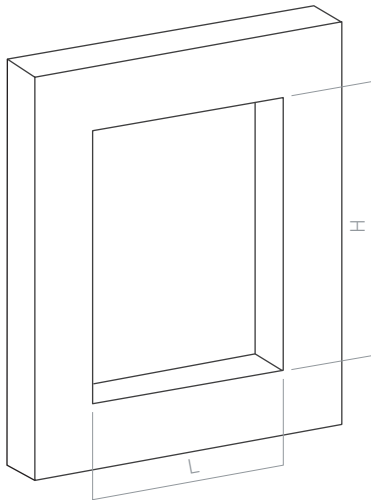

2.2 PROFILE CUTTING AND ALLOWANCES

Cut the cover and the terminal of the mosquito screen through the cutting area, with an allowance of -24 mm from the total width of the hole, make the cut at 90°, straight and uniform.

It is not advisable to cut the cover to a measurement of less than 550 mm, as this operation would involve dismantling the end cap that carries the spring and totally readjusting it.

Cut the guides, with an allowance of -55 mm from the total height of the hole. The cut must also be made at 90° and uniform. Carefully remove and clean any remaining filing residue from the cutting of the profiles.

Insert the handles, pull cord, and caps through the terminal rail.

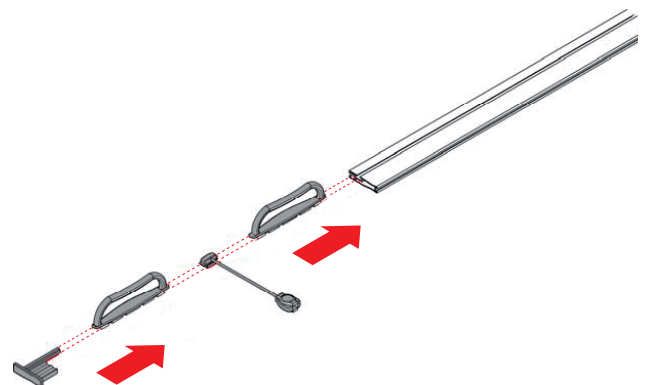
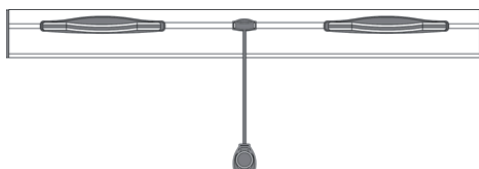
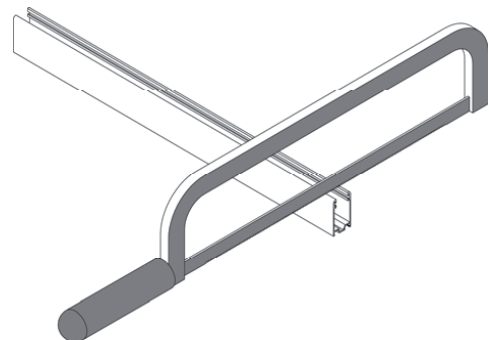

2.3 END CAP ASSEMBLY

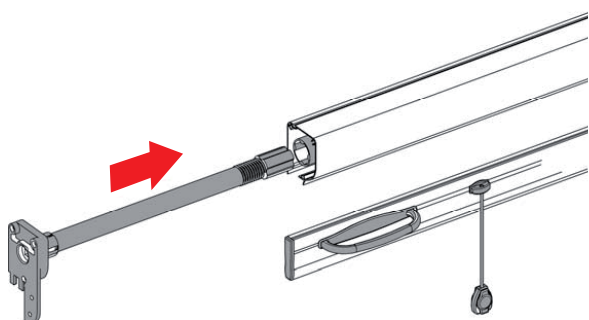

STEP 1

Insert the end cap with spring on the side, adjusting it to the grooves in the axle.

STEP 2

Turn the front end **22 times** in a clockwise direction (depending on the model of spring and cover).

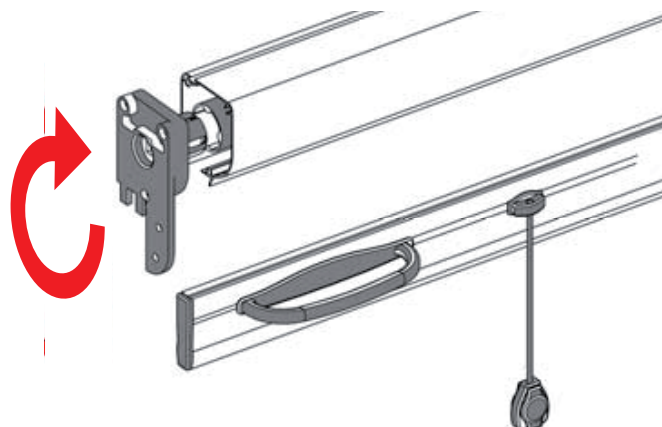

STEP 3

Fasten the end cap to the cover with screws.

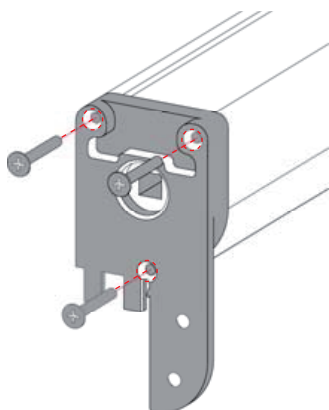

2.4 INSTALLATION OF THE QUICK FASTENING KIT

Once the end cap have been installed.

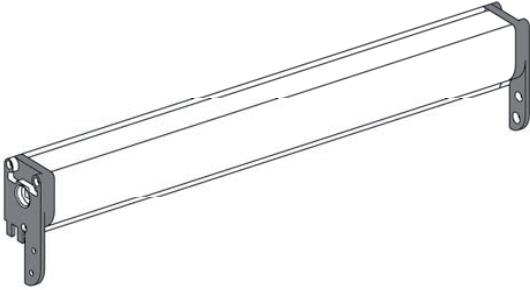

STEP 1

Insert the spring into the rod and clip into the hole in the end cap.

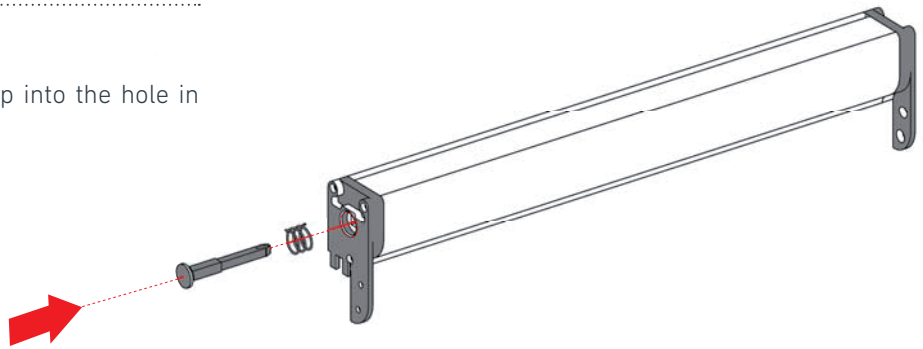

STEP 2

Adhere the 15 mm diameter rubber ring to the rod and the anti-slip ring to the side of the opposite end cap.

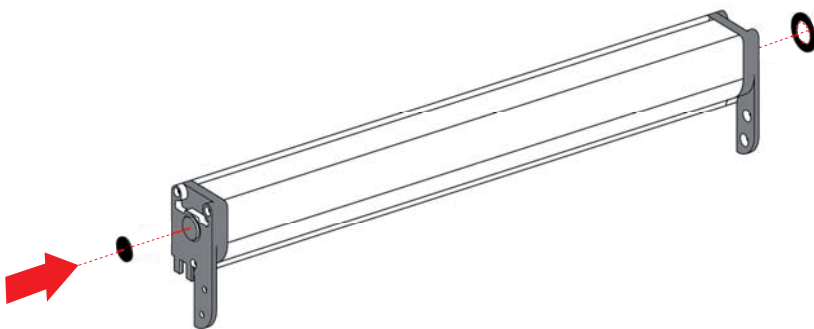

03 INSTALLATION STEPS

In the case of using a mosquito screen with a cover of 43 mm with quick installation kit, you must follow the following steps.

STEP 1

With the end of the spring-carrying cover, tilt and bring the cover closer to its final installation location.

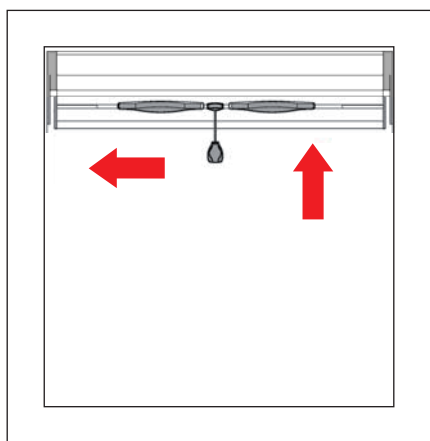
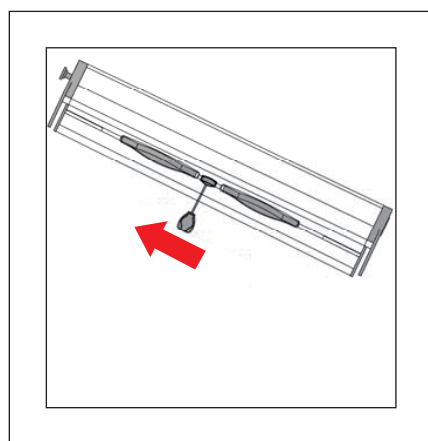

STEP 2

Press the right end of the cover against the wall and place the left end (without dragging the rubber) to the final place of installation. Secure the cover with side screws.

STEP 3

Place the adjustable hooks on the lower ends of the guides. Introduce the guides with a slight inclination on the flap of the end caps, move the lower part towards the final installation place with the hooks towards the interior of the room.

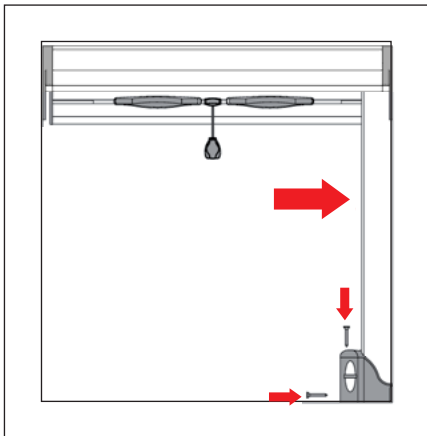
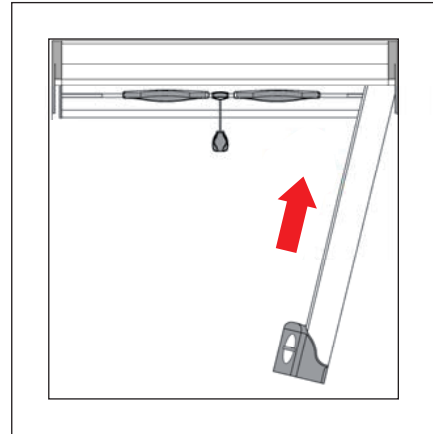

STEP 4

Fix the guides to the wall with the plugs and screws provided, ensuring that they are completely level with their covers.

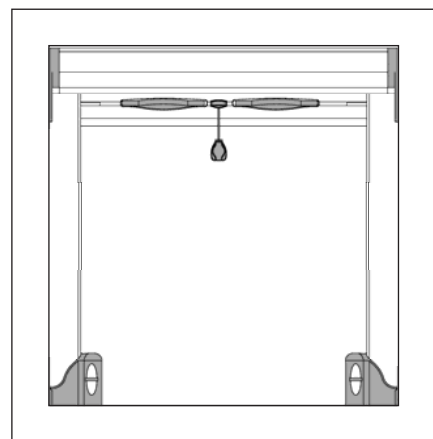

STEP 5

Lower the mosquito screen and adjust the height of the hooks until the brush on the terminal seals the bottom of the screen to the opening of the installation place. Check the screen operates correctly, opening and closing several times.

